

Building Sketch

Borrower/Client				
Property Address	1604 S Troost Ave			
City	Tulsa	County	State	OK Zip Code 74120
Lender				

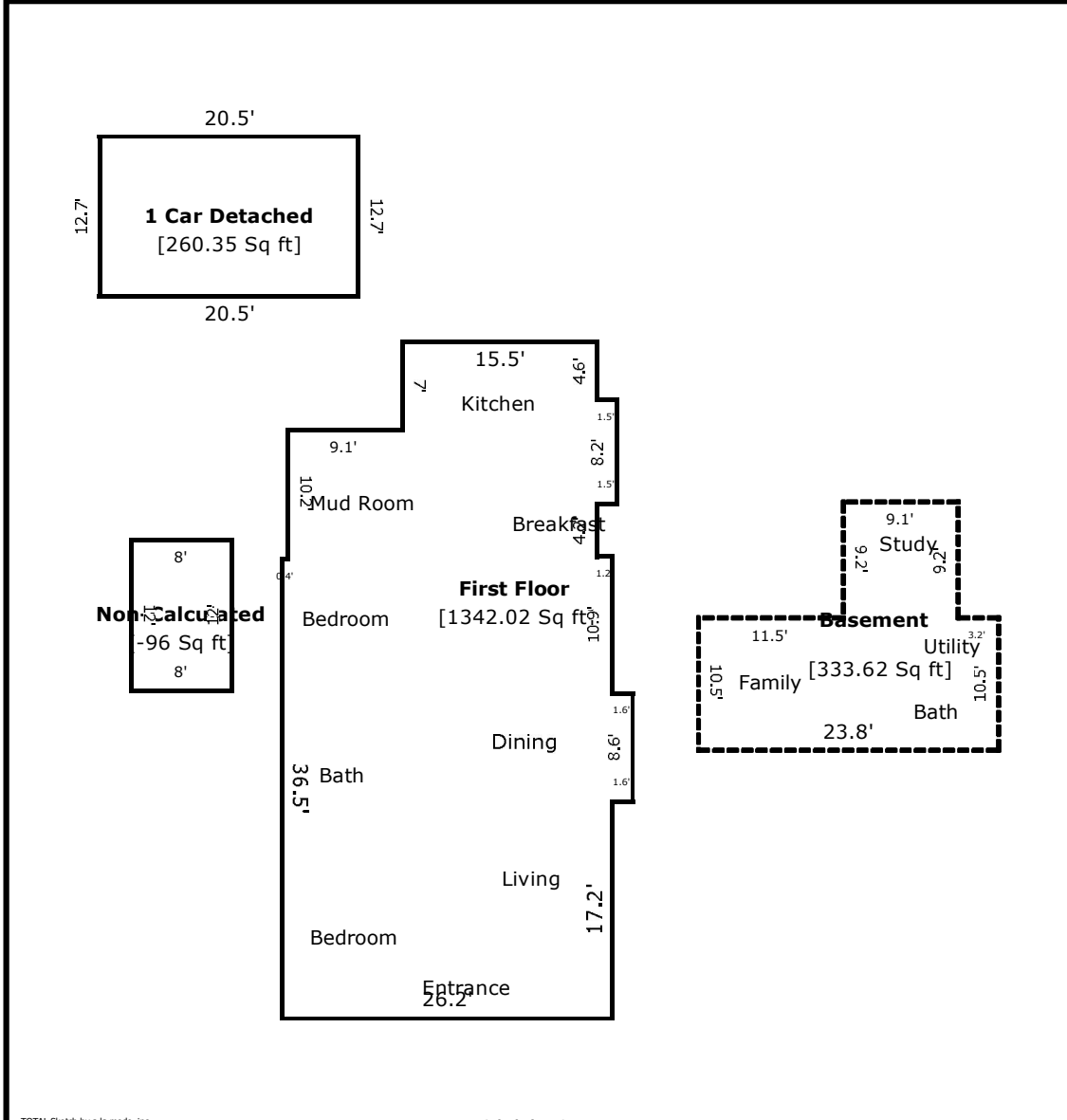

TOTAL Sketch by a la mode, inc.

Area Calculations Summary

Living Area		Calculation Details
First Floor	1342.02 Sq ft	$8.6 \times 1.6 = 13.76$ $8.2 \times 1.5 = 12.3$ $26.2 \times 36.5 = 956.3$ $10.2 \times 9.1 = 92.82$ $15.5 \times 17 = 263.5$ $0.2 \times 16.7 = 3.34$
Total Living Area (Rounded):	1342 Sq ft	
Non-living Area		
Basement	333.62 Sq ft	$9.1 \times 9.2 = 83.72$ $10.5 \times 23.8 = 249.9$
1 Car Detached	260.35 Sq ft	$20.5 \times 12.7 = 260.35$